



New Mayor, Toshiro Maruyama, his first day to Hakuba Village Office

The new mayor of Hakuba Village.



The first speech of new mayor to the officers

On July 10, the voting was held and Mr. Toshiro Maruyama, 47, was elected and became the 18th mayor of Hakuba Village. Youngest ever elected to serve a four-year term. August 8 was his first day in Hakuba Village office and his first speech to the officers.

Arigatogozaimashita and Otsukaresamadeshita



The last day of Former mayor, Masatake Shimokawa

During his eight-year term as village mayor, he led us through an unprecedentedly tough and demanding administration with the Great Kamishiro Earthquake and the COVID-19. He was also a leader in declaring a climate emergency to the world early on and in protecting Hakuba Village, where tourism is the primary industry.

「日本での生活に便利！マイナンバーカードを作りましょう」
Make your life in Japan easier !
Let's obtain Individual Number Card

○マイナンバーカードとは What is an Individual Number Card?

日本に3ヶ月を超えて滞在する外国籍の方は、マイナンバーカードを申請・取得することができます。(「短期滞在」、「外交」、「公用」の在留資格を除く。)
 マイナンバーカードは、プラスチック製のICチップ付きカードで券面に氏名、住所、生年月日、性別、マイナンバー(個人番号)と本人の顔写真等が表示されます。

Foreign nationals who will stay in Japan for longer than three months can apply and obtain an Individual Number Card, so-called "My Number Card" in Japanese. (Foreign nationals with the status of residence of "Temporary Visitor", "Diplomat" and "Official" are exempted.)
 The Individual Number Card is a plastic card with IC chip embedded, and the holder's name, address, date of birth, sex, and the Individual Number printed on the face of the card.



○どんな時に使うのか When and how to use the card?

- 健康保険証として(2021.1.3~) As a health insurance card (starting from March 2021)
- コンビニでの住民票の写しの取得 To obtain a copy of your resident certificate at convenience stores (starting from April 2023)
- 所得税のオンライン申告 Online application for income tax

○申請手続 Application Procedure:

- ①写真を用意(縦4.5cm×横3.5cm)します。
 Prepare an ID photo (4.5 cm high × 3.5 cm wide)
 ※ 直近6ヶ月以内に撮影した、正面、無帽、無背景のもの
 ※ A portrait photo should be taken within the last six months, with front view of the face, without a hat, and with plain background.
- ②申請用紙に記入します。Fill in the application form
 申請書のダウンロードは↓こちらのサイトから
 Please download the application form from the link below ↓
<https://www.kojinbango-card.go.jp/hpsv/wpmng/documents/tegaki-kofu-shinseisho-en.pdf>
- ③日本への入国時に申請書を持参してください。
 Please bring your application form when you enter Japan.
- ④日本へ入国後、お住まいの市区町村に転入届を行う際に、申請してください。
 Once you settle in Japan, please apply for your Individual Number Card at the city or ward office where you reside.
 ⇒約1ヶ月後、マイナンバーカードが交付されます。
 It will take approximately one month for issuance of the card.

Frequently Asked Questions (FAQ)

- Q1. What is an Individual Number?
- A. The "Individual Number" system assigns each individual who resides in Japan a number. It is a system that enables your information which is held by several administrative offices to be confirmed and measures for social security, tax, and disaster prevention purposes to be conducted promptly and precisely. The Individual Number System contributes to the more effective offices, improvement of convenience of residents, and accomplishment of fair and impartial society.
- Q2. Do I have to apply for Individual Number Card?
- A. Applying for an Individual Card is not legal obligation. Yet, it is used to verify individuals in the course of various administrative procedures. Starting from March 2021, it is planned to be used as a health insurance card since it has a digital certificate functionality. It will improve the level of convenience for living in Japan, and we highly recommend it to as many people as possible to apply for the card.
- Q3. Can children apply for Individual Number Card?
- A. Yes, Children under the age of 15 and adult ward shall have legal representatives to apply for the card on their behalf.

Q4. Is it required to attach a portrait photograph on the Individual Number Card application form?

A. Yes, a photograph needs to be put on the application form. Please put your photo with your name and the date of birth on the back of it within the space provided on the form.

Note: The photograph is required to be taken within the last 6-months prior to the application date, facing forward, without a hat, and with plain background.

Q5. Is there a fee to apply for Individual Number Card?

A. Currently, there is no fee for the service. However, it will cost to reissue a replacement card due to loss or other reasons.

Q6. Are there any other methods to apply for the Individual Number Card beside the methods described on the front side?

A. After making a certificate of residence, your residency will be registered. Subsequently, an Individual Number Card application form will be sent to your address. You can apply by any of the following methods:

- ① **Apply via smartphone**
Take your photo with a smartphone and apply using the QR code to access the website.
- ② **Apply via computer**
Take your photo with a digital camera and go to the URL link right.

<https://www.kojinbango-card.go.jp/en-kofushinse-pc/>

③ **Apply via postal mail**
Put the photo on the application form. Put the application form in an envelope and drop it into the postbox

④ **Apply via photo ID booths in some cities**

Take an instant photo ID at a booth that has a screen to apply for an Individual Number Card.

⑤ **Apply at a local municipal office where you live.** (Excluding some municipal offices)

※If you apply at the counter of your local municipal office, the card will be sent to you via postal mail.

This leaflet is published by the Ministry of Internal Affairs and Communications.



The second phase of Myna Point, which grants

points worth 7,500 yen each to those who register their My Number card as a health insurance card or as a public money receiving account, began on June 30, 2022 and this is for those who have applied for a my number card by the end of September.

The government has already awarded up to 5,000 yen worth of points to new my number card holders as part of the first round of my number points.

You can inquire about your My Number Card and Myna Points in English, Chinese, Korean, Spanish, and Portuguese.

Phone number: 0570-028125
The Ministry of Internal Affairs and Communications

Myna Point Support Desk

My number card must be read to make a reservation or apply for Myna points.

The procedure can be completed at the Resident Division of Hakuba Village office. An appointment is required for the procedure before you come to us.

Post offices, convenience stores, and cell phone stores also have terminals for making reservations and applying for Myna points.

For inquiries: Resident Division, Hakuba Village office
TEL:0261-85-0715

The General Affairs Division introduces Hakuba Village businesses' Zero Carbon Vision initiatives.

Woody biomass fuel

Forest trees absorb and fix atmospheric carbon dioxide through photosynthesis. Burning the wood from these forests as energy produces carbon dioxide, but if the forest grows after the trees are cut down, the carbon dioxide is absorbed back into the trees during their growth. The use of wood for energy has carbon neutral



The owner of Albergo Il Bosco

properties dioxide in the atmosphere that do not affect the concentration of carbon.

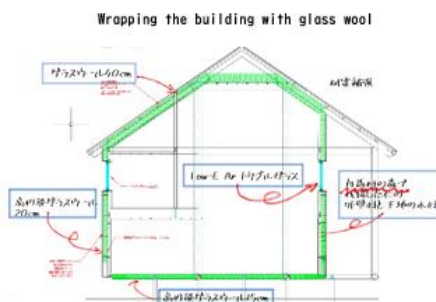

The entire building was wrapped around with the objective of reducing the consumption of firewood.



Hot water produced by a wood-fired boiler supplements the entire building.



In summer, solar generates electricity well.

Aim for 100% natural energy!

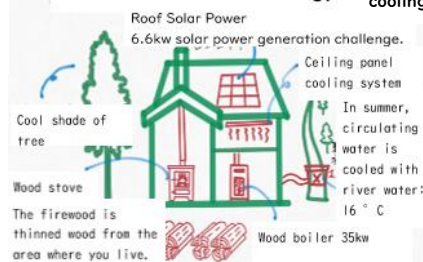

In summer, cold river water is used for cooling.



Hot-water ceiling heaters with pipes attached to steel corrugated plates are installed in all guest rooms.

Hot water from the wood-fired boiler is stored in three tanks and used for bathing, hot water supply, and whole house heating.



For inquiries: General Affairs Division, Hakuba Village Office
TEL: 0261-72-7002

Calendars of Health and Welfare Services (From 25th to the end of next month)



◆Health check-up for infant and toddler

Venue: Fureai Center 1F		
Date	Event	Child targeted
Aug 25 (Thu)	Consultation for 2-month-old	Born in Jun. 2022 ※At Kosodate Shien Room
Aug 26 (Fri)	Consultation for 2-year-old	Born in May 16 - Jul 2020
Aug 29 (Mon)	Physical Development Consultation	Appointment needed
Aug 31 (Wed)	HOP Class ③	Born in Apr. - May 15 2020
Sep 2 (Fri)	HOP Class ①	Born in 15 May - July 2020
Sep 5 (Mon)	Consultation for Childcare	Appointment needed
Sep 7 (Wed)	Health Check-up for Infant	Born in April 2020 and October 2021

◆Vaccination

Venue: Fureai Center 1F	
Date	Event & Child targeted
Sep 6 (Tue)	Immunization for Infant Notified Individually
Sep 9 (Fri)	Japanese encephalitis vaccine 1st Additional Vaccination Notified Individually
Sep 21 (Wed)	Immunization for Infant Notified Individually

◆Kosodate Shien Room

	Project/Event	Target Child	Time
Aug 25 (Thu)	Yummy Day ☆Appointment needed	Pre Nursery school child	11:20~
Aug 30 (Tue)	Nakayoshi Hiroba (Play with water)	Pre Nursery school child	10:30~
Sep 1 (Thu)	Yummy Day ☆Appointment needed	Pre Nursery school child	11:20~
Sep 6 (Tue)	Nakayoshi Hiroba (Let's Exercise!)	Pre Nursery school child	10:20~
Sep 8 (Thu)	Nakayoshi Hiroba (Let's Exercise!) Enjoy taste good "Ton-Jiru" ☆Appointment needed	Pre Nursery school child	10:30~
Sep 13 (Tue) Sep 15 (Thu)	Nakayoshi Hiroba (Let's Exercise!)	Pre Nursery school child	10:30~

※Registration is required to use the Kosodate Shien Room. Please fill out the registration card when you use the room for the first time.
 ※Currently, the Kosodate Shien Room offers Free Use Services Sunday through Friday from 9:30 a.m. to 12:00 p.m. and 1:00 p.m. to 4:00 p.m.

☆Please contact the Kosodate Shien Room to make an appointment for above events.
 ※When using the Kosodate Shien Room, please be sure to take your child's temperature at home before coming to the room.
 ※When you enter the room, please wash your hand and also your child's hands, and then fill out the health checklist first.

※ Since the children will be playing outdoors, please bring a change of clothes for your child, a towel to wipe off wet or sweaty bodies after playing in the water, and a water bottle with a drink. Water play may be cancelled due to weather.
 ※The room may be closed or the opening hours may be changed depending on the COVID-19 infection situation. If you

have any questions, please contact the Kosodate Shien Room.
 ※Notices from the Kosodate Shien Room will also be posted on the Hakuba Village official website and the Hakuba Village Maternal and Child Health Handbook application "Ohisama Memories by BO-SHI-MO: 母子モ".
 For inquiries: Kosodate Shien Room at 0261-72-3025.

◆Clinic, Hospital and Pharmacy on Duty on Holiday

Date	Hakuba/Otari	Omachi	Ikeda/Matsukawa	Dental Clinic	TEL (Area Code: 0261)	Pharmacy in Hakuba
Aug 28 (Sun)	Shintani Clinic	Omachi Municipal General Hospital	Ota Clinic	Hirabayashi DC	Omachi 22-1149	
Sep 4 (Sun)	Otari Clinic	Nomura Clinic	Matsumoto Clinic	Kirari DC	Matsukawa 62-0005	
Sep 11 (Sun)	Shintani Clinic	Ito Clinic	Azumi Hospital	Miyashita DC	Omachi 22-0297	
Sep 18 (Sun)	Kamishiro Clinic	Ishizone IM & Surgery Clinic	Serizawa Clinic	Morooka DC	Ikeda 62-9781	Fujinoya
Sep 19 (Mon)	Hakuba Clinic	Kakishita Clinic	Yoshimura Clinic	Sunada DC	Omachi 22-0648	Fujinoya
Sep 23 (Fri)	Yokosawa Clinic	Endo Internal Medicine Clinic	Azumi Hospital	Okae DC	Matsukawa 62-9888	Fujinoya Hakuba Apple
Sep 25 (Sun)	Shintani Clinic	Mogami Orthopedic Surgery Clinic	Midori Clinic	Takeuchi DC	Ikeda 62-2151	Fujinoya

◆If anything's troubling you please contact the following offices

Multicultural Living-Supporter by ANPI (Association of Nagano Pref. for Internationalization) Weekdays 9:30 - 17:30 Contact 026-235-7186	Foreign-language Human Right Hotline (English) By Tokyo Legal Affairs Bureau Weekdays 9:00 - 17:00 Contact 0570-090-911 (Navi Dial)
---	--

Exemption from payment of sewage fees

Those who newly connect to the public sewerage system during the fiscal years 2022 - 2023 will be exempted from paying the sewerage fee for 12 months. (Excludes newly constructed buildings.)
 For inquiries: Water and Sewer Division, Hakuba Village Office
 TEL: 0261-85-0714

The 62nd Hakuba Village Athletic meet: Undokai, scheduled for Sunday, September 4, 2022, at the Hakuba Cross Country Course "Snow Harp," has been cancelled to prevent the spread of the COVID-19 infection. The day will be designated as "Villager's Health and Sports Day," and radio exercises will be broadcast on the disaster prevention radio and cable TV from 8:30 a.m. The Hakuba Village B&G Pool will be open to Hakuba Village residents free of charge in the afternoon.
 For inquiries: Kominkan, Hakuba Village Office
 TEL: 0261-85-0726

The Taxation Division shares a village tax story this month, as well as last month, in a question-and-answer format.

- Q. Why did I have to pay by direct debit payments in the past, but this year I have to pay by payment slip?
- A. If the taxpayer changes due to inheritance or other reasons, the account transfer will not be continued and payment will be made by payment slip. If you wish to continue to make direct debit payments, you must submit another direct debit request form.
- Q. What happens if my account balance is insufficient?
- A. If a transfer cannot be made due to insufficient balance, the transfer will be made again at the

- beginning of the following month. A notice of reassignment will be mailed by postcard in advance.
- Q. I pay my light motor vehicle tax by direct debit. Is it possible that Taxation Division issue a tax payment certificate to be used for vehicle inspection?
- A. Hakuba Village Office Taxation Division will send you a notice of account transfer payment and a tax payment certificate upon confirmation of payment. Please find that the light vehicle tax payment certificate (for vehicle inspection), which can be used for vehicle inspection, is attached to that notice. If payment is made by credit card or smartphone payment application by the due date, a light vehicle tax payment certificate (for vehicle inspection) will be sent later.
- Q. What happens if I accidentally

- make a duplicate payment?
- A. If you have paid too much tax or have been corrected to pay less tax than you have already paid, we will process a refund for you. (However, any village taxes owed to you will be allocated first.) We will then send you a letter confirming the bank account to be refunded to you.
- Q. If I pay with a credit card or smartphone payment app, will you issue a receipt?
- A. Hakuba Village will not issue receipts for them. Therefore, if you need a receipt or need a tax certificate immediately after payment, payment should be made in cash at the payment location indicated on the back of the payment slip.

For inquiries: Taxation Division, Hakuba Village Office
TEL: 0261-85-0712

Subsidy for the purchase of wood and pellet stoves in FY2022

Since 2008, Hakuba Village has subsidized one-third of the purchase price (up to 100,000 yen) of pellet stoves for individual residents and companies as a measure to prevent global warming.

Starting in FY2022, a subsidy of one-half of the purchase price (up to 100,000 yen) will also be provided for the purchase of wood stoves, since the use of thinned wood generated by forest improvement projects as firewood can contribute to the reduction of carbon dioxide emissions.

1. Application period for grant applicants: From 9:00 am. Thursday, September 1, 2022
2. Venue: Agricultural Division,

Hakuba Village office
3. Number of stoves: 3 of wood stoves, 2 of pellet stoves (Limit one stove per person)

Note:

- ① If the number of applicants exceeds the number of stoves available when registration opens at 9:00 a.m., the grant recipients will be determined by lot drawing.
- ② If the number of accepted stoves is less than the number of applications at the time of registration, applications will be accepted at any time from 8:30 to 17:15 at the counter of the Agricultural Division until the number of accepted stoves is reached.

※ Stoves must be purchased only from

stores with offices or distributors in Nagano Prefecture.

4. Pellet stove

- ① Since the purpose of this project is to increase the consumption of pellets produced in Shinshu, the following precautions must be observed.
- ② Pellet stoves must be stoves that use pellets as fuel.
- ③ Hakuba Village and distributors sign agreement (for 3 years) for fuel supply of pellets produced in Shinshu. A copy of the agreement will then be sent to the purchaser.

5. Raffle Drawing Method

- ① The first raffle is used to determine the order in which the second raffle will be drawn. The order is from the person with the earliest numbered ticket.
- ② The second lottery draw will be conducted in the order of the earliest numbers in the first result, and will end when all winning numbers have been drawn. Winners will be given an application form.

For inquiries: Agriculture Division, Hakuba Village office
TEL: 0261-85-0766

Deadline for payment of this month

※ For payment by credit card, an additional fee based on the tax amount is required.

	Payment due date	A/C transfer :Kouza Furikae	Payment Method				
			Cash		A/C transfer	Credit card	Electric Payment Services
			At the accounting section of Hakuba Village Office and the banks in Hakuba Village	At Convenience Store			
4th of 10 payments National Health Insurance	Sep 30 (Fri)	Sep 26 (Mon)	○	○	○	—	—
Sep. bill of Water & Sewer	Sep 26 (Mon)	Sep 26 (Mon)	○	○	○	—	—

For inquiries: Taxation Division TEL: 0261-85-0712, Water and Sewer Division TEL: 0261-85-0714, Hakuba Village Office